

NOTES:

STEP 1. All parts of the connector are shown. A compression tool is necessary to complete the connection.

STEP 2. Strip the cable inner conductor, dielectric, braid, and jacket as shown using Corex II or equivalent strip tool.

STEP 3. Insert the center conductor and dielectric with foil into the center diameter of connector. Push connector onto the cable while rotating the connector 1/2 a turn. No braid should be visible behind the connector. Check for proper insertion depth in the braid depth window.

STEP 4. Continuity test cable before crimping to ensure a good connection.

STEP 5. Compress connector where shown using tool(s) listed or any other equivalent compression tool.

* When using with Taperwire 3GIG products, peel back & cut off 2" of the pink peel-off liner. Release the coax by breaking the adhesive by gently running a screwdriver or blade down both sides of the conductors. Be careful not to cut through the clear or white backing material. Peel tape away from the conductors & trim off even with the peel-off layer. Proceed to Step 1.

REVISIONS	Date
INITIAL DRAWING RELEASE	08/09/06

SLC-RCA-MINI25

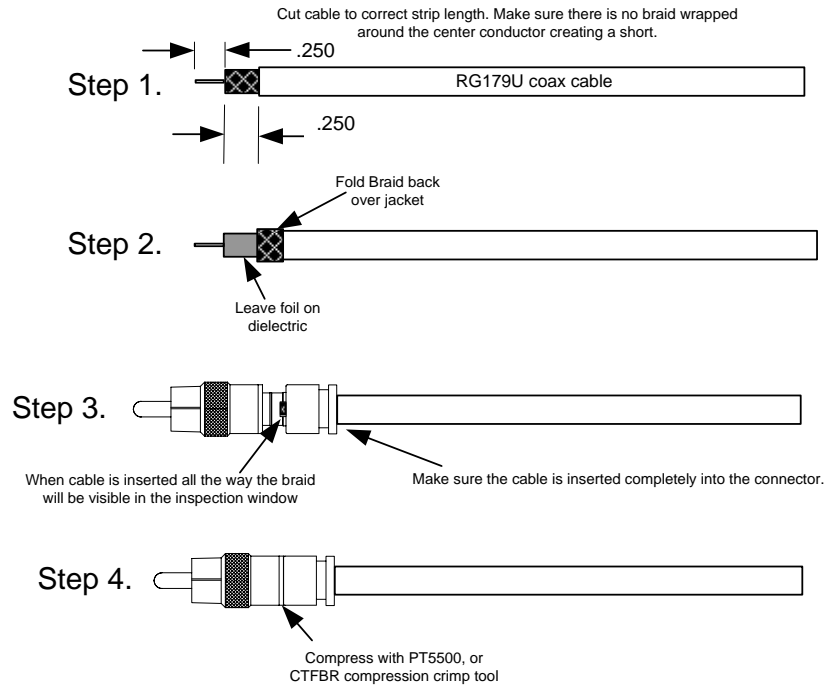
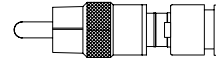

Connectors, crimp tools and finished Taperwire Assemblies are available from White Sands Engineering at 1-800 JUMPERS(586-7377) or www.whitesandsengineering.com.

THIS DRAWING IS THE PROPERTY OF WHITE SANDS ENGINEERING AND CONTAINS INFORMATION OF A CONFIDENTIAL AND PROPRIETARY NATURE. NEITHER THIS DRAWING NOR ANY OF THE INFORMATION CONTAINED HEREIN MAY BE REPRODUCED, USED, OR DISCLOSED TO OR FOR THE BENEFIT OF ANY OTHER PERSON OR ENTITY WITHOUT THE EXPRESS WRITTEN CONSENT OF WHITE SANDS ENGINEERING.

DRAWN BY:	Date
J. Lynch	08/09/06
UNLESS OTHERWISE NOTED	
1) DIMENSIONS ARE IN INCHES	
2) CABLE LENGTH TOLERANCES	
00.00" - 12.00"	.25"
12.01" - 24.00"	.50"
24.01 - 80.00"	.75"
80.01 - 300.00"	1.00"

White Sands Engineering
21615 N. 27th Avenue Phoenix AZ
1-800-586-7377

DWG Title: SLC-RCA-MINI25 Assembly Instructions

Scale:	None	SHEET 1 OF 1	Rev	B
--------	------	--------------	-----	---

APPLICABLE CONNECTORS